

M960-400

SCHEMATIC

BURR KING

1220 TAMARA LANE
WARSAW, MO. 65355

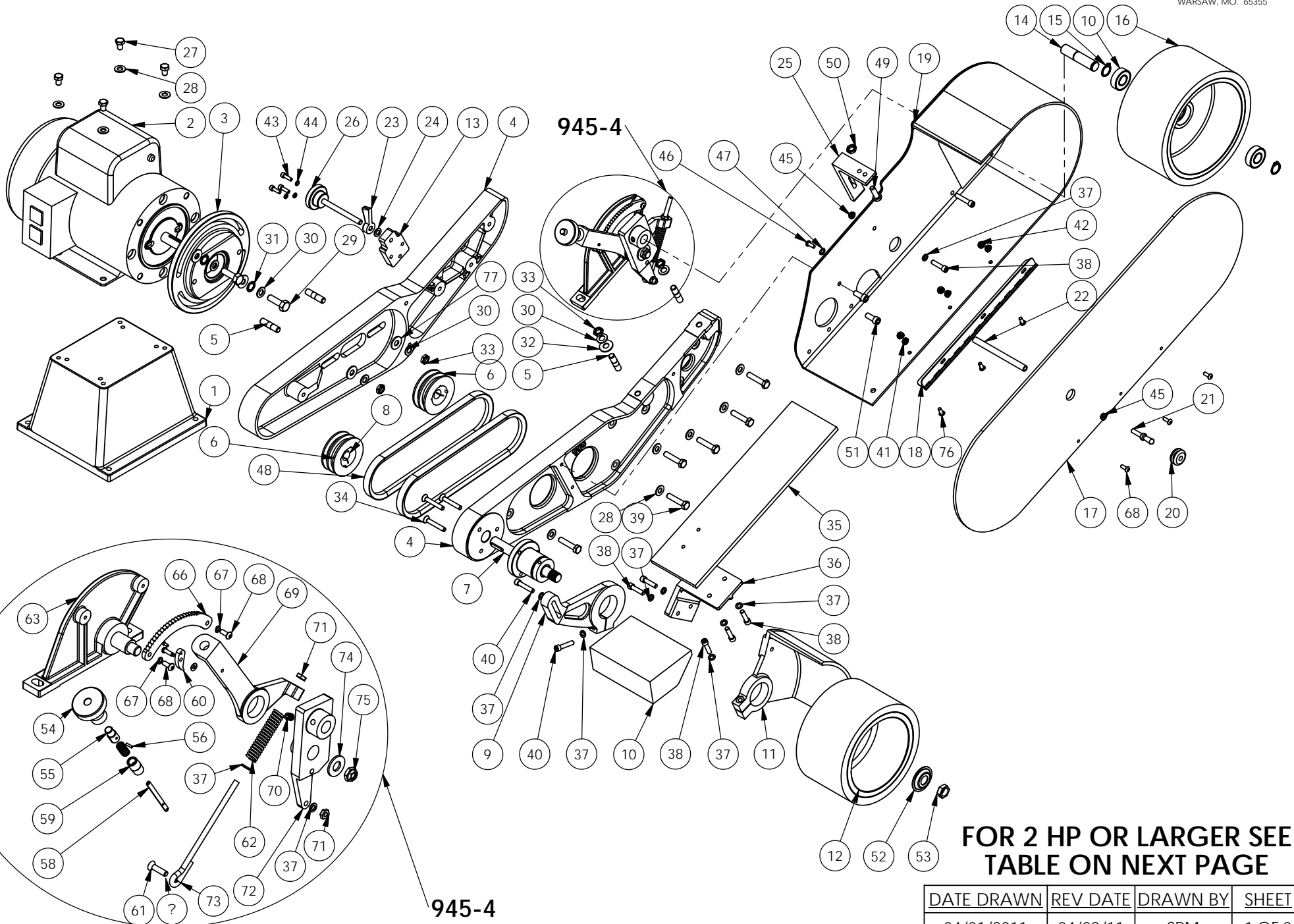

**FOR 2 HP OR LARGER SEE
TABLE ON NEXT PAGE**

DATE DRAWN	REV DATE	DRAWN BY	SHEET
04/01/2011	04/08/11	SRM	1 OF 2

M960-400

ITEM NO.	PART NUMBER	DESCRIPTION	QTY.
1	941	BASE	1
2	MOTOR	CALL FACTORY	1
3	908	ADAPTER, C-FACE MOTOR	1
4	900-4A	FRAME, GUARD	1
5	920	STUD 3/8"x1 1/2", DOUBLE	4
6	933	PULLEY, USES 947 BUSHING	2
7	701	SHAFT, BEARING	1
8	947	BUSHING	2
9	905-4	ARM, WORKREST SUPPORT	1
10	906-4	WORKREST, ANTITILT	1
11	903-4	GUARD, CONTACT WHEEL	1
12	802-4	CONTACT WHEEL	1
13	923-4	BRACKET, TRACKING	1
14	707c	SHAFT, BEARING	1
15	701F	WHEEL, IDLER CIR-CLIP	2
16	907-4	WHEEL, IDLER, WITH BEARING	1
17	942B	DOOR, GUARD	1
18	742E	HINGE	1
19	942-4A	GUARD, SAFETY, PAINTED	1
20	742H	GROMMET, SAFETY GUARD DOOR	1
21	742L	LATCH, SAFETY GUARD DOOR	1
22	942C-4	STANDOFF, DOOR	1
23	922	LOCK, KNOB, TRACKING	1
24	18	WASHER, 960-516, AN	1
25	924	SUPPORT, BACKUP	1
26	921-4	KNOB, TRACKING ASSY	1
27	2	BOLT, 5/16-18x1 1/2 HEX HEAD	4
28	4	WASHER, 5/16 SAE ZINC PLTD	10
29	1-0003	3/8-16 x 1 1/4 HEX HEAD BOLT	2
30	17	WASHER, 960-616, AN	6
31	5-0014	WASHER, LOCK 3/8, INTERNAL STAR	2
32	40	WASHER, SAE, 3/8	1
33	39	NUT, 3/8-24, JAM, ESNA, NTE	4
34	6	1/4-20 x 1 1/2 FH SOC	3
35	904-4A	PLATEN	1
36	904B	BRACKET, PLATEN	1
37	5	WASHER, 1/4 AN	10
38	30	1/4-20x1 SHCS	6
39	1-0019	BOLT, 5/16-18x1 1/2 HEX HEAD	6
40	31	1/4-20x1 1/4 SHCS	3
41	14	NUT, 10-24, KEP	3
42	23	NUT, 6-32, KEP, PLTD	3
43	2-0023	SCREW, 10-24 X .625 ALLEN HEAD	3
44	5-0036	WASHER, #8, LOCK, INTERNAL	3
45	4-0013	NUT, KEP, 1/4-20	2

M960-400

ITEM NO.	PART NUMBER	DESCRIPTION	QTY.
46	29	SCREW, 10-32 X 1/2 BH	1
47	5-0032	WASHER, 1/4, LOCK, SPLIT, PLTD	1
48	951	BELT, V DRIVE	2
49	1	BOLT, 5/16-18x1, HH, GRD 5, PLTD	1
50	4-0009	NUT, 3/8-16, JAM, PLTD	1
51	2-0001	1/4-20x1 1/4 SHCS	2
52	726	WASHER, SPRING FLANGE	1
53	727	NUT, 5/8-18 RH, JAM, BRT PLT	1
945-4			
ITEM NO.	PART NUMBER	DESCRIPTION	QTY.
54	737A	KNOB, REAR TENSION ARM	1
55	737B	BUTTON	1
56	26	PIN, 3/32 x 3/8, ROLL PLTED	1
57	737D	SPRING, BUTTON	1
58	937C	STRIP	1
59	737E	NIPPLE, PIPE	1
60	737F	PAWL	1
61	34	SCREW, 1/4-20 X 1, FH PHILLIPS	1
62	738	SPRING, BELT TENSION	1
63	940	SUPPORT, IDLER WHEEL	1
64	27	SCREW, DRIVE, #8 X 5/8	1
65	28	SCREW, DRIVE, #2 x 1/4	1
66	736	RACHET	1
67	15	WASHER, 5/16 LOCK, SPLIT	2
68	9	SCREW, 10-24x1/2 BH, BLK OXIDE	5
69	937G	HANDLE	1
70	25	SCREW, SET 5/16-18 x 3/8	1
71	3	NUT, 1/4-20 JAM, PLTD	2
72	935	SUPPORT, REAR WHEEL	1
73	939	GUIDE, SPRING	1
74	21	WASHER, 1/2 ID	1
75	20	NUT, NYLOK JAM, 1/2-20	1
76	24	SCREW, 6-32 x 1/2, MACH	3
77	42	WASHER, SAE, 3/8	4
78	5-0027		1



1220 TAMARA LANE
WARSAW, MO. 65355

1 1/2 HP	CHANGES TO	2-3HP	BUSHINGS	
730		931	949 5/8"	950 7/8"
725		933	947 5/8"	
429		951 2(qty)		

TITLE	DATE DRAWN	REV DATE	DRAWN BY	SHEET
M960-400	04/01/11	04/08/11	SRM	2 OF 2