



BURR KING MFG. CO., INC

1220 Tamara Lane

Warsaw, MO 65355

www.burking.com

(660)438-8998 • 800-621-2748

Fax (660)438-8991

**MODEL 1272
INSTRUCTION
MANUAL**

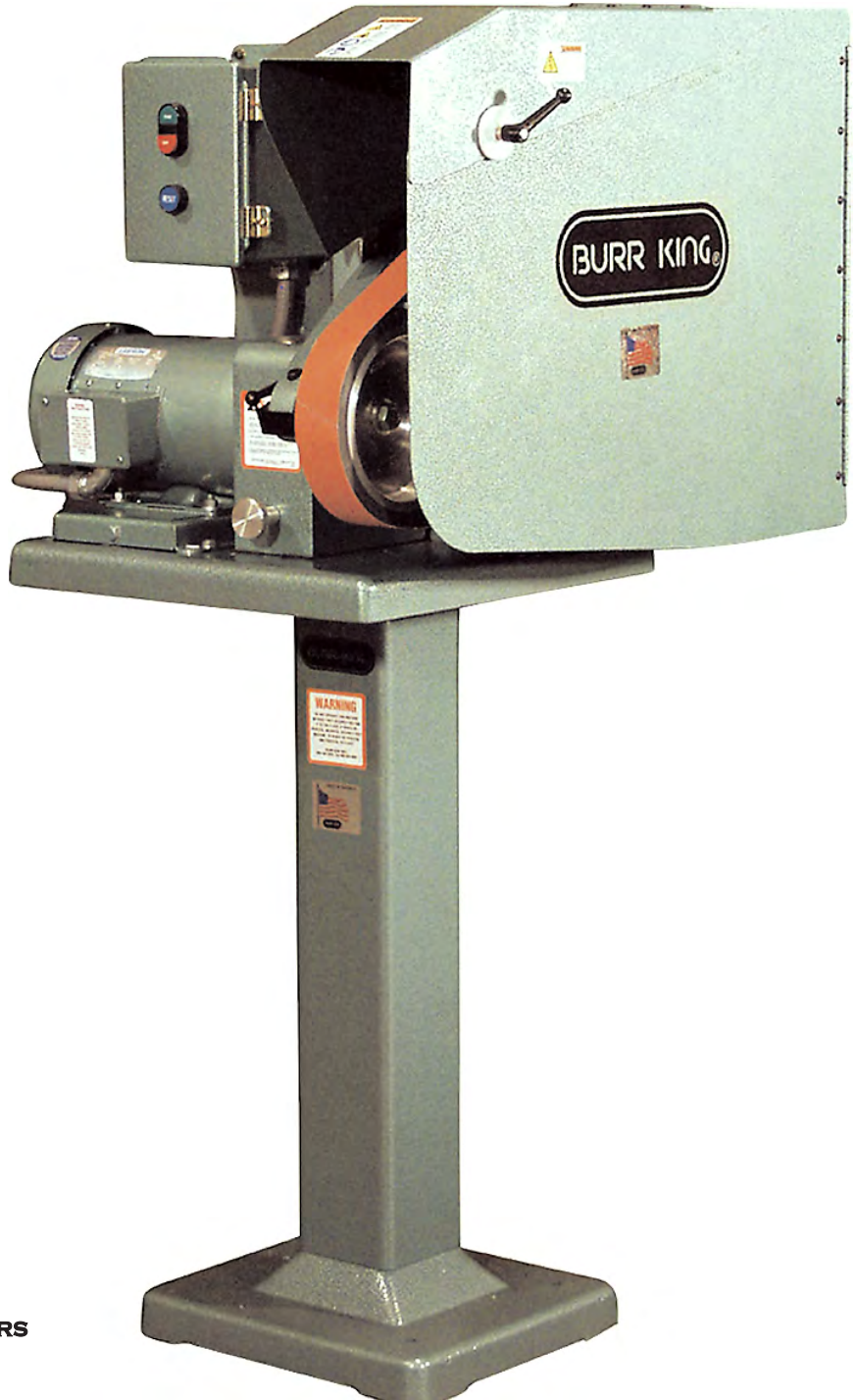

MADE IN U.S.A.



- * GRINDERS
- * BUFFERS
- * VIBRATORY
- * DISC GRINDERS

**BURR KING MODEL 1272
GRINDER**

This page intentionally
left blank



BURR KING MFG. CO., INC.

1220 TAMARA LANE

WARSAW MO 65355

WWW.BURRKING.COM

(660) 438-8998 ♦ (800) 621-2748

FAX (660) 438-8991

June, 2007

Burr King Manufacturing Company, Inc. warrants the below product to be free in material and workmanship. The period of warranty is 1 year (90 days for vibratory bowls of 20 quart and lesser volume) from the date of purchase. No warranty is provided for products that have been modified, abused, handled carelessly, where repairs have been made or attempted by others, or for freight damage. No warranty is provided for three phase electric motors, controllers, etc. when the motors, controllers are not protected by magnetic starters that were supplied and installed by Burr King Manufacturing Company, Inc. No other warranty, written or verbal is authorized by Burr King Manufacturing Company, Inc.

During the warranty period Burr King Manufacturing Company, Inc (or its authorized suppliers or agents) will replace or repair the below product without charge if the product is found by Burr King Manufacturing Company, Inc. to be defective. To receive warranty services you must contact Burr King Manufacturing Company, Inc. and receive authorization for warranty service. Unless otherwise authorized by Burr King Manufacturing Company, Inc. Products (see * below) must be returned to the factory to receive warranty service.

*Motors, speed controllers, and certain other accessories are warranted by their respective manufactures. To receive warranty service on these items you must contact a brand label service center that supports the product in need of service. Burr King Manufacturing Company; Inc. will assist you in locating a service center.

For the first thirty days after purchase, and when Burr King Manufacturing Company, Inc. authorizes warranty service, we will pay normal and necessary surface freight charges both ways (except for items in *). After thirty days the customer is responsible for all freight charges. Where possible Burr King Manufacturing Company, Inc. may elect to make on site service and/or repairs necessary to return the product to serviceable condition.

To assure prompt warranty service it is necessary that you complete and return the below warranty information to Burr King Manufacturing Company, Inc. please **FAX** or **MAIL** at your convenience.

Product model: _____ Serial number: _____
Date Purchased: _____ Purchased from: _____
Address: _____ City: _____ State/Prov: _____ Postal code _____

Your company name: _____
Address: _____ City: _____ State/Prov: _____ Postal code _____
Phone: _____ Fax: _____ Email: _____
Your name: _____ Title: _____

How did you learn about Burr King products?

Trade show ___ Web ___ Industrial Distributor ___ Advertisement ___ Other _____ Which one: _____

What is the intended use of this product? _____

Please indicate the general work types performed at your company, check all that apply:

Fabrication ___ Machining ___ Casting ___ Molding ___ Welding ___ Finishing ___ Assembly ___ Research ___ Other ___

Please indicate the primary product focus of your company; check all that apply.

Aircraft/Missile ___ Automotive ___ Contract machine ___ Contract Fabrication ___ Agricultural ___ Maintenance ___ Recreational ___
Job shop ___ Foundry ___ Construction ___ Arts ___ Orthopedic ___ Dental ___ Medical ___ Other _____

Please tell us what we can do to improve our products:

May we contact you? Yes ___ No ___

Thank you for purchasing Burr King products!

**REGISTER ONLINE @
WWW.BURRKING.COM**



BURR KING MFG. CO., INC.

1220 TAMARA LANE

WARSAW MO 65355

WWW.BURRKING.COM

(660) 438-8998 • (800) 621-2748

FAX (660) 438-8991

August 29, 2007

LETTER OF AUTHENTICITY

This letter is to certify that all Burr King Belt grinders, Disc grinders, Polishing machines Vibra King Chambers and Bowls are manufactured and assembled in the United States of America.

(Tariff number 847990 criterion A)

A handwritten signature in black ink that reads "Don Mac Carthy". The signature is written in a cursive style with a large, stylized initial "D".

Don Mac Carthy
President

See our catalog at www.burrking.com

contact us at info@burrking.com



BURR KING MFG. CO., INC.

1220 TAMARA LANE

WARSAW MO 65355

WWW.BURRKING.COM

(660) 438-8998 ♦ (800) 621-2748

FAX (660) 438-8991

February 2005

OPERATOR, and OPERATING AREA SAFETY

Subject equipment includes Grinders, buffers, polishers, and other rotating equipment. Serious injury or death may occur if minimum safety precautions are not understood, and obeyed by operators and those other persons who may be in the immediate vicinity of the subject equipment. Persons who operate, or are in the immediate vicinity of the subject equipment must be properly trained in, and use, minimum safety precautions and procedures for such machinery.

Minimum safety requirements to operate, or work in the immediate vicinity subject equipment:

1. Read and understand all operating instructions, manuals, labels, and other information provided with the equipment.
2. Install the equipment according to manufacturer's instructions.
3. Securely bolt the equipment to a rigid, structurally sound mounting surface.
4. Use and wear proper eye and face protection.
5. Use and wear proper protection for the body, hands, fingers, feet, and legs.
6. Review and understand all machine guards, adjustments, and points of exposure to potential injury.
7. Do not remove, tamper with, or otherwise alter, equipment guards, and other safety features.
8. Insure the machine is adjusted, and remains adjusted according to manufacture's requirements.
9. Maintain the equipment in good operating condition.
10. Have another person who is knowledgeable in proper and safe operation of the subject equipment demonstrate proper and safe operation to all operators, and to those persons who might be in the immediate vicinity of the subject equipment.
11. Use work piece holding devices when ever possible that diminish the possibility that persons will come in contact with moving machine pieces, or spark/debris output from the machine.
12. Use spark and debris arresting apparatus. Such apparatus should be connected to the machine so as to contain dust and debris that is generated, and to suppress sparks thereby limiting human inhalation risk, and the risk of fire or explosion.
13. Use appropriate inhalation apparatus to protect person from ingestion and/or inhalation of sparks, debris, smoke, particulates, etc.
14. Avoid mixing different metals, alloys, and materials. To mix such materials might create a fire or explosion hazard.
15. Protect persons from work pieces, particulates, etc. that could be forcibly ejected from the machine. For example, a buffing wheel or grinding belt can "grab" a work piece while the work piece is being buffed, polished, ground, or otherwise conditioned, resulting in forcible ejection toward the operator or those in the vicinity of the machine. The use of leather aprons, gloves, and eye shields are examples of protective gear that may be effective. In general do not grind, buff, or otherwise engage the traveling belt, wheel, or disc surface with the work piece pointing into the direction from which the belt, wheel, or disc is traveling. However, if you choose to do so be aware the work piece may lodge in the traveling belt, wheel, or disc and be forcibly, and dangerously ejected.
16. Do not operate this machine if the gap (nip point) between a moving belt, wheel or disc and the work support surface exceeds 1/8 inch.
17. Do not operate this machine if the gap between the moving abrasive belt, disc or wheel and the adjacent face

page 1 continued on next page

See our catalog at www.burrking.com

Contact us at info@burrking.com

Continued from page 1

of the work rest (or table) will permit passage of the work piece through the gap (nip point). Note, however, that certain alloys such as titanium may create conditions where grinding debris can accumulate in a tight gap creating a potential fire hazard. **When in doubt consult with your safety officer.** Failure to observe this warning may result in the work piece or other item being caught in this gap, and/or being forcibly ejected. Failure to heed this warning may cause serious bodily harm to the operator and/or bystanders. **NEVER USE THIS EQUIPMENT IF YOU ARE NOT PROPERLY TRAINED IN ITS OPERATION and/or SAFE USE! IF IN DOUBT STOP and ASK FOR GUIDANCE!**

18. Never position the work rest table at an acute angle between the top of the work rest table and the moving belt or wheel. Doing so will create “nip point” that can cause serious injury should an operator body part become entangled (pulled into) the nip point created by this acute angle.

19. Do not operate the equipment, or allow others to operate the equipment without proper training in these and other rotating machinery safety requirements.

20. Do not perform maintenance on the equipment unless you are fully qualified to do so, and understand all necessary safety and operating requirements.

21. Do not leave the machine unattended while it is running.

22. Correct equipment or safety problems immediately. Do not operate the equipment when it requires maintenance, or correction.

23. Install and use high quality abrasive belts, wheels, discs, media, etc., as appropriate to your machine. Understand and follow the operating requirements provided by the manufacturer of these materials.

Rotational Speed Warning, Contact Wheels

Scope: Contact wheels manufactured by Burr King Manufacturing Company, Inc., which have rubber or urethane tires. Examples include but are not limited to stock codes 202, 302, 402, 502, 702, 802, 902, 1002, 1202 and variants. Variants have stock codes that begin with the base number; i.e. 802-S-55 is an 802 variant.

Users are warned not to exceed the below listed revolutions per minute (RPM) on the subject wheels. Failure to heed this warning may lead to tire de-bonding, fragmentation, or other mechanical failure. Such failures may cause serious personal injury to operators or bystanders, and/or cause property damage. All Burr King products are warranted for various time periods to be free of material and/or workmanship defects. Burr King Manufacturing Companies standard warranty policy is summarized as follows for contact wheels. 1 year from date of purchase if mounted on a Burr King machine purchased on the same date or 90 days if purchased as a spare or replacement part. Our warranty does not apply to wheels that are mounted on products not manufactured by Burr King Manufacturing Company, Inc. Users who mount Burr King manufactured contact wheels on product not manufactured by Burr King Manufacturing Company, Inc. do so at their own risk and assume all liability for having so mounted the contact wheel(s).

Remember good safety practice demands guarding to protect operators and bystanders from wheel failure and/or debris. Never use the subject contact wheels without proper guarding that meets commonly accepted safe practice. See OSHA, U/L, CSA, CE, ISO and other respected safety standards.

<u>Stock code</u>	<u>Maximum Safe RPM</u>
202, 302	10000
402, 502, 702 802	4400
902, 1002	2200
1202	1600

Page 2, continued on page 3

Continued from page 2

Occupational Noise Exposure

Burr King products produce levels of noise consistent with their intended purposes. The level and spectral content of noise produced is dependent on the product type, the degree that the product is maintained in proper operating condition, the abrasive/media and accessories used, the specific application, and the surrounding environment. Noise levels produced by various Burr King grinders and polishers, as measured at the Burr King factory, range from 80 to 93 decibels. Product operators and persons in the immediate product vicinity should be protected from excessive noise does levels as prescribed in OSHA regulation 29, piece 1910.95 titled "Occupational Noise Exposure".

ROTATING EQUIPMENT CAN BE DANGEROUS TO OPERATORS AND THOSE WHO MAY BE IN ITS IMMEDIATE OPERATING VICINITY. IT IS THE ABSOLUTE AND DIRECT RESPONSIBILITY OF PURCHASERS, MANAGERS, AND OPERATORS OF THIS EQUIPMENT TO UNDERSTAND AND OBEY THE FOREGOING MINIMUM OPERATING SAFETY REQUIREMENTS. IF YOU HAVE QUESTIONS OR SAFETY CONCERNS REGARDING OPERATING THE SUBJECT EQUIPMENT PLEASE CALL YOUR AUTHORIZED BURR KING DISTRIBUTOR, OR BURR KING MANUFACTURING AT 1-800-621-2748. YOUR SAFETY IS OUR FOREMOST CONCERN!

Burr King Manufacturing disclaims any and all responsibility for injuries, damage, loss of income, or other adverse consequence as might be incurred by purchasers, managers, and operators of this equipment.

Page 3 is last page



BURR KING MFG. CO., INC.

1220 TAMARA LANE

WARSAW MO 65355

WWW.BURRKING.COM

(660) 438-8998 • (800) 621-2748

FAX (660) 438-8991

January 2001

Operating instructions for Burr king model 1272

Overview: the model 1272 burr king is a multi-wheel, rear wheel drive abrasive belt grinder that operates at selectable belt speeds. Various accessories can be mounted on the machine that together with the base machine provide contact, work rest, platen, and slack belt grinding. The machine requires minimal maintenance.

Safety precautions, to avoid personal injury or death:

*Operators must always wear appropriate eye, hand, and body protection when grinding with the model 1272.

*Never perform maintenance on the model 1272 with the main power supply connected.

*Stay clear of all rotating parts to the model 1272.

*Keep clear of the model 1272 and its grinding debris stream.

*Never permit flammable material near the model 1272 while grinding.

*Never mix materials while grinding that may be chemically incompatible. To do so may create a serious fire or health hazard. Examples include titanium, tantalum, etc.

General operating instructions(refer to outline drawing M1272 for control location and identification)

Belt installation:

1. Open the safety guard door
2. Press the red button on the belt tension control and release the lever forward, lift handle with black button to release tension
3. Remove the old belt and discard
4. Install the new belt taking care to observe belt direction as may be indicated on the back side of the belt. Install the belt so that the belt preferred direction of travel will be counter clock wise when viewing the Model 1272 from its left switching wiring.

Note: the direction of belt travel can be reversed by switching wiring connections within the motor wiring box. Follow the instructions on the motor label plate.

5. Press the belt tension control to the rear until it is about half way through the provided spring travel. This will provide normal belt tension and the tensioning control will automatically adjust for minor belt stretching as may occur
6. Apply power to the model 1272

Belt tracking:

1. Tension the belt as required above
2. If the belt is tracking off of the center of the contact wheel, adjust the belt tracking control as required to center the belt.

Changing belt speed:

1. Disconnect main power
2. Open the drive belt safety cover
3. Reposition the drive belt to the desired speed position

BELT POSITION

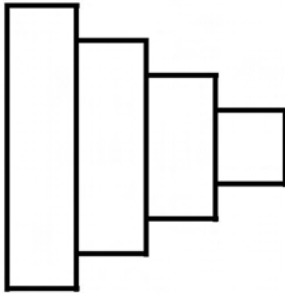
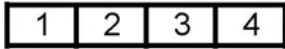

REAR DRIVEN PULLEY

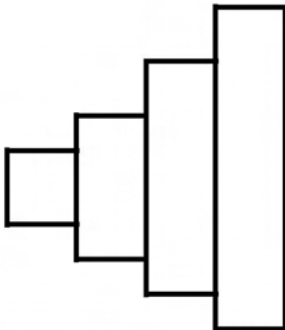

FRONT MOTOR PULLEY

PULLEY POSITION	SFPM WITH DRIVE WHEELS DIAMETER IN INCHES			
	3	4	5	7
1	677	902	1128	1579
2	1083	1444	1805	2527
3	1692	2256	2821	3949
4	2708	3611	4513	6319

Installing the 1275 yoke:

1. Remove the contact wheel (8" standard) by loosening and removing the 5/8-18 flex nut and flange washer. (also remove workrest support if installed)
2. Install the 1275 yoke over the contact wheel bearing housing.
3. Tighten the set screw that is to the rear of the housing that is fitted over the bearing housing.
4. Install the 5/16 allen bolt and washer through the half moon slot
5. Position the 1275 as required for the best work position
6. Tighten the allen bolt
7. The position of the 1275 effects belt tension, it may be necessary to loosen the rear wheel mount locking device and reposition the rear wheel to achieve proper belt tension
8. Tension and track the belt as required

Installing the 1276 or 1277:

1. Remove the platen assembly from the 1275 yoke
2. Remove the lower contact wheel by loosening the retaining set screw and sliding the wheel away from the assembly
3. Install the fork assembly using two 1/4-20 allen bolts, securing the assembly. To the lower front of the 1275 yoke
4. Install, tension and track the belt as required

Installing the 1411 or 1412 internal grinding attachments:

1. Remove the contact wheel and/or the 1275 yoke if installed
2. Install the 1411/1412 over the contact wheel housing
3. Position the 1411/1412 to the desired position and tighten the clamping device
4. Install and track the belt

Installing the 1002 and other contact wheel sizes:

I. All available contact wheels can be installed on the model 1272 by using various combinations of idler, quantities, diameters, and positions. All wheel accessories are provided with the necessary compliment of other wheels if they are not part of the standard machine configuration. The Model 1272 will accept tension and track many combinations of wheels because of its flexible design. This permits many grinding eometries to be achieved.

Maintenance:

1. Drive belt tension should be periodically checked to assure the belt has about 1/2 inch deflection under moderate pressure. Adjust the drive belt tension by loosening the motor mount bolts and retightening after setting belt tension.
2. There are no grease, or oil fittings on the model 1272. Moving surfaces may be periodically oiled with a thin film of light machine oil. Excessive oil attracts dust and debris and should be avoided.
3. Cosmetic surfaces may be cleaned with a clean cloth.

MODEL 1272



* NOTE: TYPICALLY SHOWS BOLT-NUT-WASHER SETS AS 1 ONLY
NUMBER OF SETS NEEDED VARIES ACCORDING TO LOCATION ON GUARD

1242 SAFETY GUARD COMPLETE

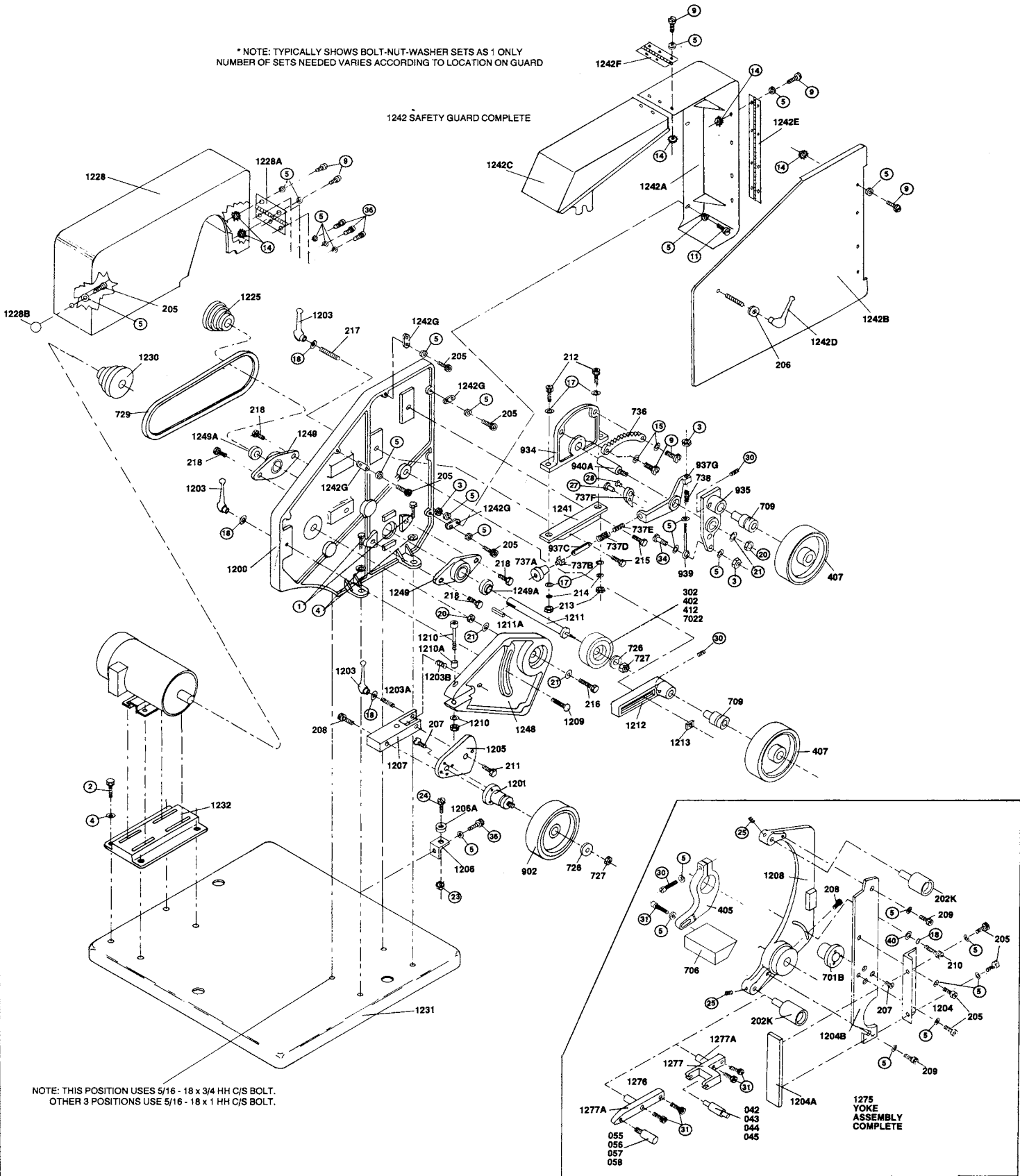

NOTE: THIS POSITION USES 5/16 - 18 x 3/4 HH C/S BOLT.
OTHER 3 POSITIONS USE 5/16 - 18 x 1 HH C/S BOLT.

1275
YOKE
ASSEMBLY
COMPLETE

MODEL 1272

PART #	DESCRIPTION	QUANTITY
1	5/16 - 18 x 1 HH C/S BOLT	3
2	5/16 - 18 x 1/2 HH C/S BOLT	4
3	1/4 - 20 JAM NUT	5
4	5/16 USA WASHER	8
5	.265 .500 .063 AN960-416 WASHER	39
9	10/24 x 1/2 FILL HD M/S	17
11	1/4 - 20 x 3/4 FILL HD M/S	3
14	10/24 KEPNUT	15
15	#10 L/W	2
17	.390 .625 .063 AN960-616 WASHER	4
18	.328 .562 .063 AN960-516 WASHER	4
20	1/2 - 20 ESNA NUT 21NTE080	2
21	1/2 WASHER	3
23	6 - 32 CAP NUT	1
24	6 - 32 x 3/8 PAN HEAD M/S	1
25	5/16 - 18 x 3/8 SOC SET SCREW	2
27	8 x 5/8 DRIVE SCREW	1
28	0 x 1/4 DRIVE SCREW	1
30	1/4 - 20 x 1 SOC CAP SCREW	2
31	1/4 - 20 x 1 1/14 SOC CAP SCREW	4
34	1/4 - 20 x 1 FLAT HD M/S	1
36	10 - 24 x 5/8 SOC CAP SCREW	4
40	3/8 WASHER	1
205	1/4 - 20 x 1/2 SOC CAP SCREW	9
206	FENDER WASHER	1
207	1/4 - 20 x 3/4 ALLEN FLAT HD CAP SCREW	6
208	5/16 - 18 x 1 1/4 SOC HD CAP SCREW	2
209	1/4 - 20 x 3/4 SOC HD CAP SCREW	2
210	5/16 - 18 x 2 SOC HD CAP SCREW	1
211	5/16 - 18 x 3/4 SOC HD CAP SCREW	1
212	3/8 - 16 x 1 1/4 HH C/S	2
213	3/8 - 16 HEX NUT	2
214	3/8 INTERNAL L/W	2
215	5/16 - 18 x 3/4 SOC HD CAP SCREW	2
216	1/2 - 20 x 2 1/4 HH C/S BOLT	1
217	STUD 5/8 - 18 x 2 3/4	1
218	5/16 - 18 x 1 1/4 SOL HD CAP SCREW	4
042	2" WIDE 9/16 CONTACT WHEEL	
043	2" WIDE 3/4 CONTACT WHEEL	
044	2" WIDE 1" CONTACT WHEEL	
045	2" WIDE 1 1/2 CONTACT WHEEL	
055	1" WIDE 9/16 CONTACT WHEEL	
056	1" WIDE 3/4 CONTACT WHEEL	
057	1" WIDE 1" CONTACT WHEEL	
058	1" WIDE 1 1/2 CONTACT WHEEL	
202K	2" x 2" CONTACT WHEEL WITH BEARING	
302	DRIVE WHEEL	
402	DRIVE WHEEL	
405	WORKREST SUPPORT ARM	
407	REAR IDLER WHEEL	
412	DRIVE WHEEL	
701B	HOUSING ONLY	
706	WORKREST	
709	IDLER BEARING	
726	OUTER WHEEL FLANGE	
727	CONTACT WHEEL NUT	

PART #	DESCRIPTION
729	V-BELT
737A	KNOB
737B	RED BUTTON
737D	SPRING
737E	PIPE NIPPLE
737F	PAWL
738	REAR QUICK CHANGE SPRING
902	8" CONTACT WHEEL
934	IDLER SUPPORT
935	REAR BEARING SUPPORT
937C	REAR WHEEL HANDLE STRIP
937G	HANDLE CASTING
939	SPRING GUIDE
940A	STUD
1200	MAIN FRAME
1201	CONTACT WHEEL BEARING ASSEMBLY
1203	HANDLE
1203A	STUD
1203B	SPRING
1204	ANGLE BRACKET
1204A	PLATEN 2" x 8"
1204B	SIDE MOUNTING BRACKET
1205	TRACKING PLATE
1206	STOP BRACKET
1206A	STOP BRACKET GROMMET
1207	TRACKING BLOCK
1208	YOKE CASTING
1209	ROUND/H BOLT
1210	ALLEN BOLT/WASH/NUT TRACKING BOLT
1210A	BUSHING
1211	DRIVE WHEEL SHAFT
1211A	DRIVE SHAFT KEY
1212	REAR WHEEL SLIDE
1213	LOCKING SLIDE NUT
1225	REAR PULLEY 4-STEP
1228	V-BELT GUARD
1228A	HINGE
1228B	KNOB
1230	MOTOR PULLEY 4-STEP
1231	BASE
1232	MOTOR MOUNT
1241	ANGLE PLATE FOR QUICK CHANGE ASSEMBLY
1242	SAFETY GUARD COMPLETE
1242A	GUARD MAIN
1242B	DOOR
1242C	COVER
1242D	HANDLE AND STUD
1242E	REAR HINGE FOR MAIN GUARD
1242F	TOP HINGE
1242G	MOUNTING TAB
1248	NOSE CASTING
1249	BEARING HOUSING
1249A	BALL BEARING
1275	YOKE ASSEMBLY COMPLETE
1276	1" ARM FOR 1272
1277	2" ARM FOR 1272
1277A	STUD FOR 1276 AND 1277 ARMS
7022	DRIVE WHEEL

NOTE SEE ACCESSORY SHEET FOR CONTACT WHEELS

Burr King Model 1272 Abrasive Belt Grinder

The model 1272 is a multi-wheel variable speed abrasive belt grinder that provides contact wheel, platen, work rest, and slack belt grinding. The grinder can be configured to grind several radii dimensions by selecting various sized contact wheels. Belt speed is chosen by selecting different motor drive belt positions on a multiple position drive pulley arrangement. Several accessories are available that extend the capability of the grinder.

Model 1272 abrasive belt grinder features:

- 1" or 2" belt width by 72" belt length (25mm or 50mm x 1800mm)
- 1 1/2 hp, 1725 (1425) rpm, 60(50) hertz, single phase motor*
- Selectable belt speed from 677 to 6320 sfpm (205 to 1915 sfpm)
- 7" (175mm) rear wheel drive
- Positive belt tracking
- Quick belt change and tension adjustment
- Cast iron/steel construction
- Precision machined
- Well balanced and true contact wheels and idlers

*grinders driven by 50 hertz ac power will operate at 5/6 60 hertz belt speed

*3 horsepower also available

Model 1272 accessories:

1275 yoke assembly features:

Work rest 2 1/2" x 3 1/2" (63mm x 88mm)

Back-up platen 2" x 9" (50mm x 225mm)

2" x 2" (50mm x 50mm) contact wheels, two

Required for 1276 or 1277 fork arm

Accessories for the 1275 include:

302k 2" x 3" diameter (50mm x 75mm) idler wheel

410k 2" x 4" diameter (50mm x 100mm) idler wheel

1276 uni-arm

2" x 72" (50mm x 1800mm) belt size

Choice of contact wheel diameter 1/2" (13mm), 3/4" (19mm), 1" (25mm), 1 1/2" (38mm)

Requires 1275 yoke assembly

1277 fork

Same as above but with 2" (50mm) belt width

Requires 1275 yoke assembly

1002 contact wheel

2" x 10" diameter (50mm x 250mm)

55 or 90 shore tire hardness, speciflj

Mounts to 1272 without change of standard wheel diameters

Also plain or serrated

1242 safety abrasive belt guard

Fits standard model 1272

Mounting hardware included

Hinged access door with latch

Guards all wheel pinch points

1411 full access internal grinding attachment

1" x 72" (50mm x 1800mm) belt size

Optional contact wheel sizes are 9/16" (14mm), 3/4" (19mm), and 1 1/2" (38mm)

Installs on standard model 1272

Arm extension of 5" (125mm)

1412 full access internal grinding attachment

2" x 72" (100mm x 1800mm) belt size

Optional contact wheel sizes are 9/16" (14mm), 3/4" (19mm), and 1 1/2" (38mm)

Installs on standard model 1272

Arm extension of 5" (125mm)

Model 1272 and accessories price list

<u>Part number</u>	<u>Description</u>	<u>Price/each in US dollars</u>
1272	Abrasive Belt Grinder	\$ CALL
1242	safety abrasive belt guard	\$ CALL
1275	yoke	\$ CALL
1276	1" uni-arm	\$ CALL
055	9/16" x 1" contact wheel for 1276 uni-arm	\$ CALL
056	3/4" x 1" contact wheel for 1276 uni-arm	\$ CALL
057	1" x 1" contact wheel for 1276 uni-arm	\$ CALL
058	1-1/2" x 1" contact wheel for 1276 uni-arm	\$ CALL
1277	2" fork arm	\$ CALL
038	9/16" x 1" contact wheel for 1277 fork arm	\$ CALL
039	3/4" x 1" contact wheel for 1277 fork arm	\$ CALL
040	1" x 1" contact wheel for 1277 fork arm	\$ CALL
041	1-1/2" x 1" contact wheel for 1277 fork arm	\$ CALL
Ds-12	dust scoop	\$ CALL
202k	2" x 2" idler wheel	\$ CALL
302k	2" x 3" idler wheel	\$ CALL
410k	2" x 4" idler wheel	\$ CALL
302	2" x 3" contact/drive wheel	\$ CALL
412	2" x 4" contact/drive wheel	\$ CALL
402	2" x 5" contact/drive wheel	\$ CALL
7022	2" x 7" contact wheel	\$ CALL
902	2" x 8" contact wheel	\$ CALL
1002	2" x 10" contact wheel	\$ CALL
1212	slide for 72" belt use	\$ CALL
1411	1" full access internal grinding attachment	\$ CALL
1412	2" full access internal grinding attachment	\$ CALL